



## Dial Gauge, Lug Back, ISO Type

**10mm, 0,01mm**

Item number: 2046A



### Description

#### Standard Type, 10 mm Range, 0,01 mm Graduation

This is a standard, metric dial indicator. It offers you the following benefits:

- Bezel clamp and lifting lever (optional) can be attached to either right or left side. They can be easily installed and removed without tools.
- No through screw holes on the frame and secure adhesion between the bezel and the crystal as well as the use of an O-ring prevents water or oil penetration.

### Features

Range:	<b>10 mm</b>
Range per rev.:	<b>1 mm</b>
Graduation:	<b>0.01 mm</b>
Scale:	<b>0-100 (100-0)</b>
MPE any 1/10 revolution:	<b>5 µm</b>
MPE any 1/2 revolution:	<b>9 µm</b>
MPE any 1 revolution:	<b>10 µm</b>
MPE measuring range:	<b>13 µm</b>
H MPE (Hysteresis):	<b>3 µm</b>
R MPE (Repeatability):	<b>3 µm</b>
Measuring force:	<b>0,4-1,4 N</b>
Mass:	<b>144 g</b>
Continuous dial:	<b>Yes</b>
Digital/Analog:	<b>Analog</b>
Inch-Metric:	<b>Metric</b>
Type:	<b>EN ISO Standard</b>
Stem:	<b>8 mm</b>
Contact point:	<b>Carbide tipped, thread: M 2.5 x 0.45 mm</b>
Delivered:	<b>with certificate of inspection</b>

### Dimensions

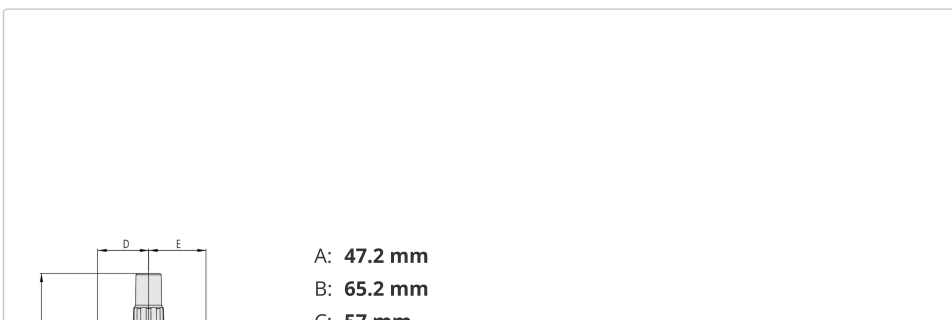

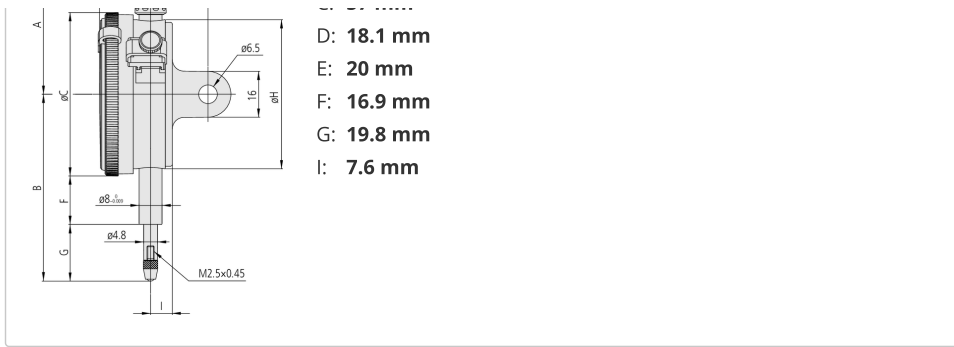

## Accessories

### Optional accessories:



**Limit Hands (green) 2pcs**  
**Dial Indicator Series 2/3/4**  
**21AZB195**  
Price on application



**Bezel Clamp for Dial Gauge**  
**Metric, Series 2/3/4**  
**21AZB148**  
Price on application



**Spindle Lifting Lever**  
**for Digital Indicator, A-Type Dial Indicator Series 2/3/4**  
**21EZA198**  
Price on application



**Spindle Lifting Cable**  
**for Indicator, L=500mm**  
**21JZA295**  
Price on application



**Spindle Lifting Cable with Auto Stop**  
**for Indicator, L=300mm**  
**21JZA301**  
Price on application

## Spare parts

### Consumable spares:



**Contact Element Ball Point, M2,5x0,45**  
**7,3mm Length, Carbide, Metric**  
**901312**